

LYCOMING AIRCRAFT ENGINE GROUP ASSEMBLY PARTS LIST

- (A) VACUUM PUMP DRIVE
- (B) FUEL PUMP DRIVE
- (C) HYDRAULIC PUMP DRIVE

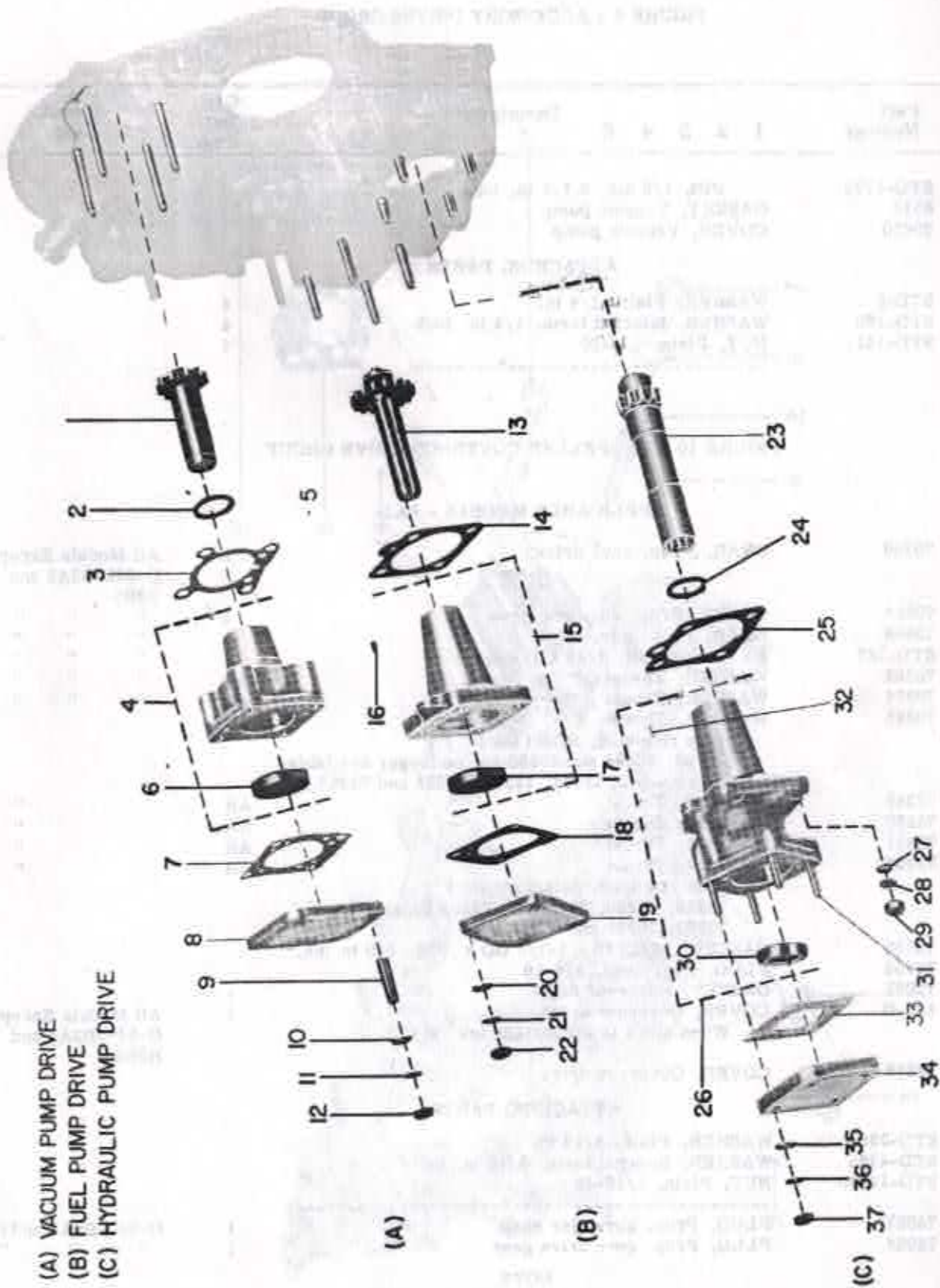

ALL MODELS

Figure 9 - Accessory Drives Group

LYCOMING AIRCRAFT ENGINE GROUP ASSEMBLY PARTS LIST

FIGURE 9 - ACCESSORY DRIVES GROUP

Ref. No.	Part Number	Description					Qty. Eng.	Model Change
		1	2	3	4	5		
APPLICABLE MODELS - ALL								
9-1	67537	GEAR ASSY., Vacuum pump driven No longer available; service with 72974.					3	
		GEAR ASSY., Vacuum pump driven Supersedes and interchangeable with 67537.					3	
2	71596	WASHER, Acc. driven gear					1	
	61163	GASKET, Acc. adapter					1	
4	67536	ADAPTER ASSY., Vacuum pump					1	
5	STD-1774	PIN, 1/8 dia. x 1/4 in. long					1	
6	STD-206	SEAL, Oil, 7/8 ID x 1-1/2 OD x 5/16 in. wide					1	
7	8313	GASKET, Vacuum pump					1	
	60430	COVER, Vacuum pump					1	
ATTACHING PARTS								
9	68593	SPACER, Vacuum pump stud (Required when no vacuum pump drive is employed)					1	
10	STD-8	WASHER, Plain, 1/4 in.					1	
11	STD-160	WASHER, Internal teeth, 1/4 in. lock					1	
12	STD-1411	NUT, Plain, 1/4-20					1	
-----*								
13	71670	SHAFTGEAR ASSY., Fuel pump drive No longer available; service with 72968.					3	C-340-A, B Series, 72968 and IO-540-C1B5
	72968	SHAFTGEAR ASSY., Fuel pump drive Supersedes and interchangeable with 71670.					3	" " "
		SHAFTGEAR ASSY., Fuel pump drive No longer available; service with 72972					3	IO-540-A1A5 and 72972
		SHAFTGEAR ASSY., Fuel pump drive Supersedes and interchangeable with 72247.					3	" " "
14	69164	GASKET, Fuel pump adapter					1	
15	69159	ADAPTER ASSY., Fuel pump drive					1	
16	STD-1774	PIN, 1/8 dia. x 1/4 in. long					1	
17	STD-213	SEAL, Oil, 3/4 ID x 1-3/8 in. OD					1	
	1691-C	GASKET, Fuel pump					1	All Models Except IO- 540-A1A5 and B1A5
19	60431	COVER, Fuel pump					1	" " "
ATTACHING PARTS								
20	STD-35	WASHER, Plain, 5/16 in.					1	
21	STD-475	WASHER, Internal teeth, 5/16 in. lock					1	
22	STD-1410	NUT, Plain, 5/16-18					1	
-----*								
23	71673	GEAR ASSY., Hydraulic pump driven No longer available; service with 72964.					3	C-340-A, B Series, 72964 and IO-540-C1B5
	72964	GEAR ASSY., Hydraulic pump driven Supersedes and interchangeable with 71673.					3	" " "
24	71596	WASHER, Acc. driven gear					1	
25	68315	GASKET, Acc. drive adapter					1	
26	71675	ADAPTER ASSY., Hydraulic pump					1	
ATTACHING PARTS								
27	STD-35	WASHER, Plain, 5/16 in.					1	
28	STD-475	WASHER, Internal teeth, 5/16 in. lock					1	
29	STD-1410	NUT, Plain, 5/16-18					1	
-----*								
30	STD-206	SEAL, Oil, 7/8 ID x 1-1/2 OD x 5/16 in. wide					1	
31	69942	STUD, 1/4-20 x 1-17/32 in. long					1	